

Cable System Overview

From poster and information display right through to signage. This system offers a range of applications perfect for use in any retail or commercial environment with its attractive yet unobtrusive finish.

Available in a stainless finish. Accommodates use with 1.5mm wire cable.



CV1500 Kit



CV1510 and VC1515 Kit



CV1506 Kit

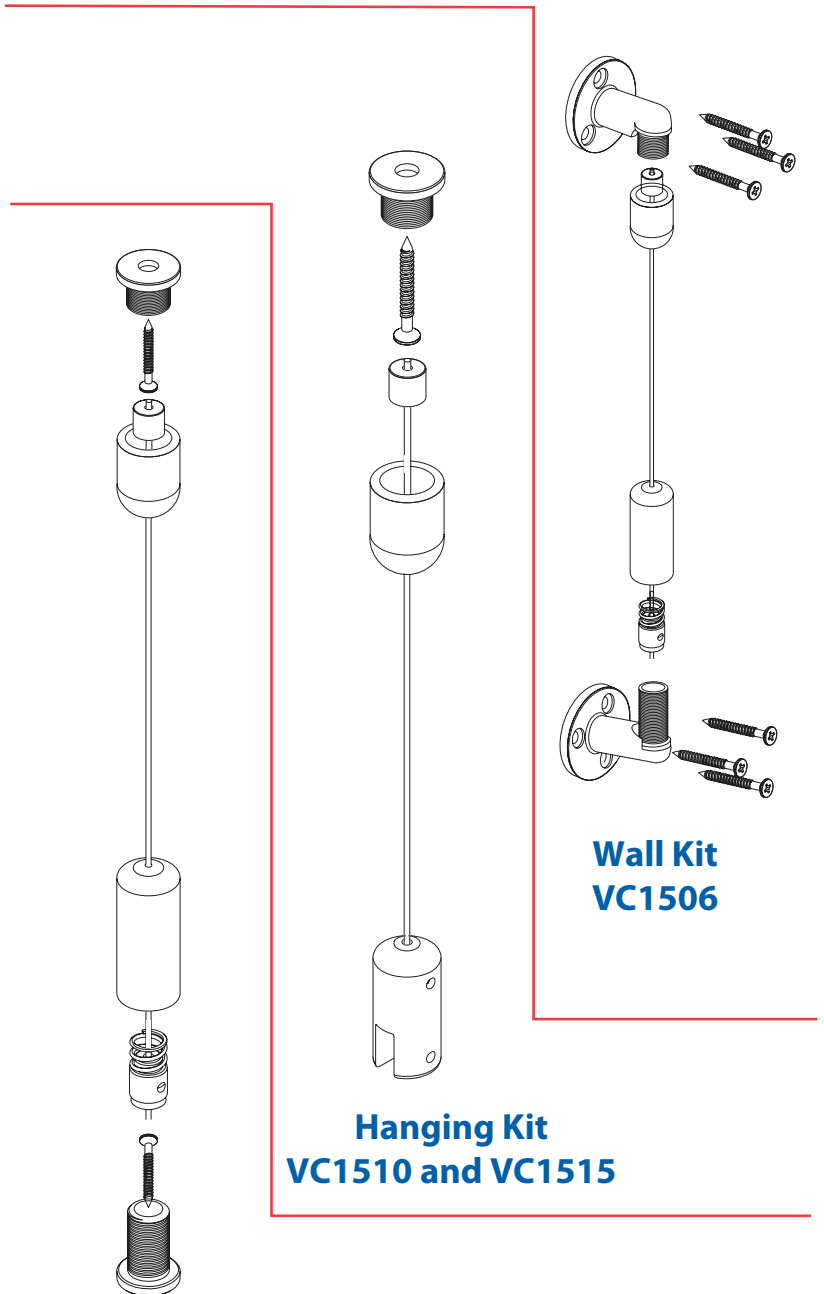
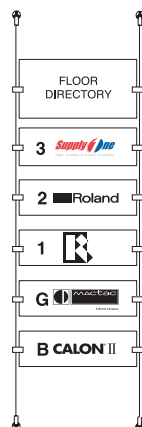

Floor to Ceiling Kit
VC1500

Hanging Kit
VC1510 and VC1515

Wall Kit
VC1506

Floor to Ceiling Kit

The **VC1500** Floor to Ceiling kit is specifically designed for fixing between floor and ceiling, allowing maximum space for signage while remaining attractive yet unobtrusive.

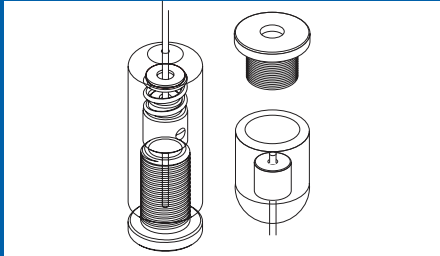

- Includes:
- 19mm diameter top Boss
 - 4m x 1.5mm diameter stainless steel cable
 - 19mm diameter adjusting sleeve
 - Floor anchor
 - Tension spring

Hanging Kit

The Hanging Kit **VC1510 and VC1515** is specifically designed for hanging signs or posters from the ceiling. The perfect alternative to other weighty systems as the hanging kit is not only unobtrusive, it is also extremely light weight.

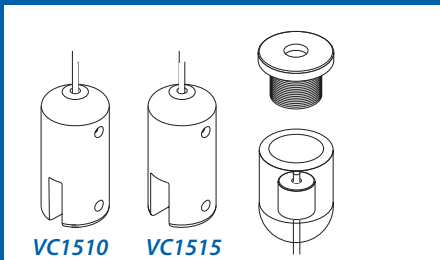

- Includes:
- 4m x 1.5mm diameter stainless steel cable
 - Adjusting Sleeve
 - Ceiling Anchor

VC1510 Kit • 19mm diameter support for 3mm panel
VC1515 Kit • 19mm diameter support for 6mm panel

Wall Kit

The **VC1506** wall kit gives your signage a fantastic projection from the wall creating a visually interesting option whilst having no impact on floor space. The tension system creates a taut line to attach the sign panel to.

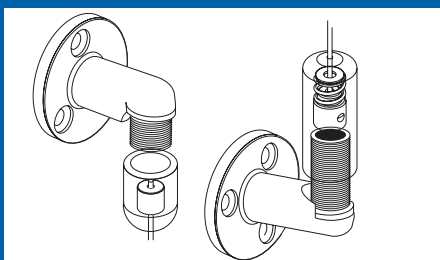

- Includes:
- 17mm diameter top Boss
 - 4m x 1.5mm diameter stainless steel cable
 - 19mm diameter adjusting sleeve
 - Floor anchor
 - Tension spring

CABLE GRIPS to suit 1.5mm cable

Used to securely hold panels at intervals along the cable.



VC1525

12mm diameter Slimline cable grip for 3mm panel.



VC1526

12mm diameter Slimline twin cable grip for 3mm panel.



VC1535

17mm diameter cable grip for up to 6mm panel.



VC1500
Floor to Ceiling Kit



VC 1510 Hanging Kit



VC1506 Wall Kit